

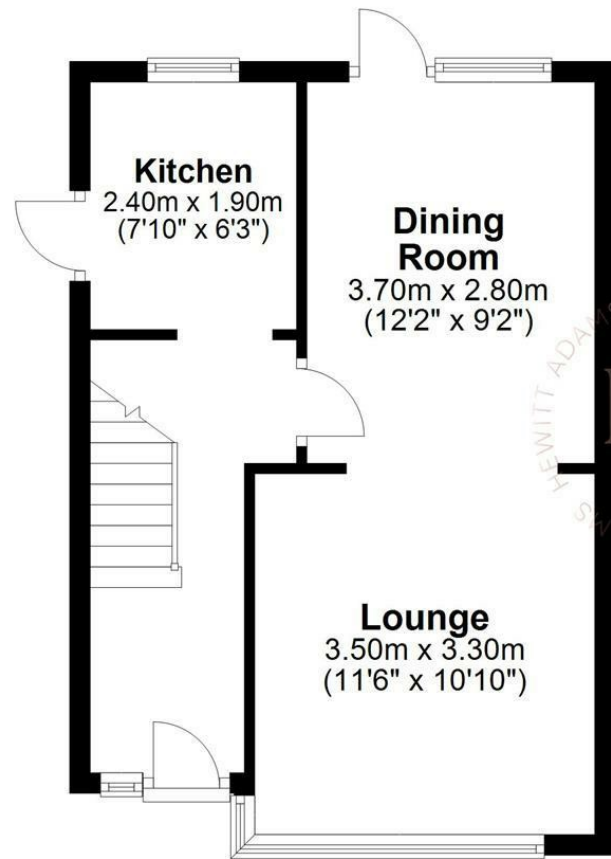

Ground Floor

Approx. 34.5 sq. metres (371.6 sq. feet)



First Floor

Approx. 34.6 sq. metres (372.3 sq. feet)

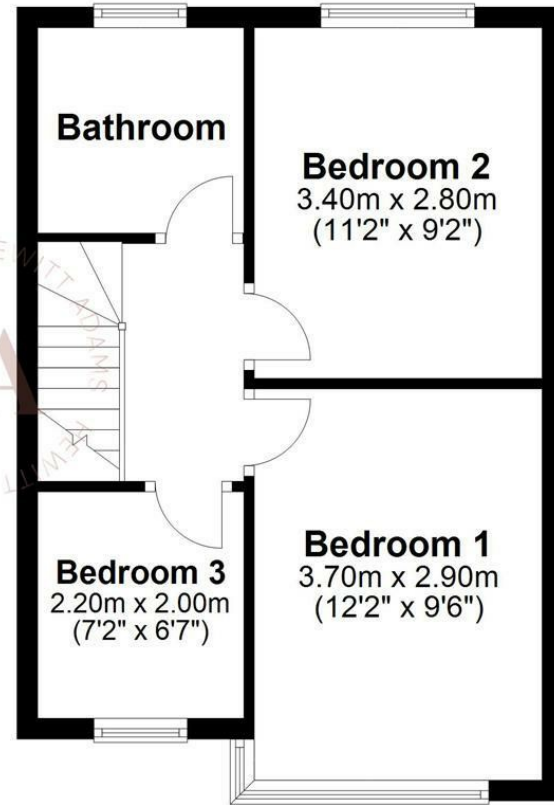

Total area: approx. 69.1 sq. metres (743.9 sq. feet)
For illustration purposes only - not to scale

Kylemore Drive, Pensby, Wirral CH61 6XS

Price Guide £250,000

3 Bedroom 2 Reception 1 Bathroom

Three Bedroom Semi - Ideal First Time Buy or Property Flip - South Facing Garden - No Chain!

Hewitt Adams is delighted to offer to the market this THREE BEDROOM semi-detached family home located on the POPULAR Kylemore Drive, a short distance from the centre of Heswall.

The property is sold with NO ONWARD CHAIN. The property does require a scheme of modernisation, however it is a brilliant blank canvas for someone. And someone could easily move in and renovate around them.

A big selling point is the SOUTH FACING rear garden!

In brief the accommodation affords; entrance hall, lounge and dining room, kitchen. Upstairs there are three bedrooms and a bathroom.

Call Hewitt Adams on 0151 342 8200 to view.

Front Entrance

Into;

Hall

Staircase to first floor, radiator

Lounge

11'5" x 10'9" (3.5 x 3.3)

Double glazed window, radiator, power points

Dining Room

9'5" x 12'1" (2.89 x 3.7)

Double glazed sliding door to garden, radiator, power points

Kitchen

6'2" x 7'10" (1.9 x 2.4)

Wall and base units, inset sink, double glazed window, side door, space for white-goods

UPSTAIRS

Bedroom

9'6" x 12'1" (2.9 x 3.7)

Double glazed window, radiator, power points

Bedroom

9'6" x 11'1" (2.9 x 3.4)

Double glazed window, radiator, power points

Bedroom

7'2" x 6'6" (2.2 x 2.0)

Double glazed window, radiator, power points

EXTERNALLY

With a generously sized rear garden that comprises of patio and lawn.

